

SC-2.4A

Sample Cooler

Compact, efficient heat exchanger to cool steam and water samples

The Solutions Inc. Sample Cooler facilitates the exchange of heat from hot sample to cooling water. Sample flows through a helical stainless steel coil. The flow of cooling water, which enters from the cooler base, is baffled to effectively remove heat from the sample as it flows around the coil.

This unit can act as a primary or secondary cooler. To avoid introducing contaminants, all components wetted during operation are made from 316 Stainless Steel.

Benefits:

- Increases accuracy of sample analyses
- Protects downstream analysis equipment
- Self-contained design requires small amount of installation area
- Combination of nested helical coils and vertical baffles creates highly efficient heat transfer environment



DETAILS

Technical Details:

Tube rating: 4000 psi @ 1000° F
Shell Rating: 450 psi @ 650° F
Weight: X.X lbs

Material:

Sample tube & bolts: 316 SS
Shell & other: 304 SS
Seal:

Part Number & Description

SC-24-A 316 SS tube and wetted components; 2.4 sq. ft. HX surface area

DETAILS

Technical Details:

Heat Exchange Area: 2.4 sq. ft.
Tube rating: 4000 psi @ 1000° F
Shell Rating: 450 psi @ 650° F
Weight: X.X lbs

Material:

Sample tube & bolts: 316 SS
Shell & other: 304 SS
Seal:



DIMENSIONS

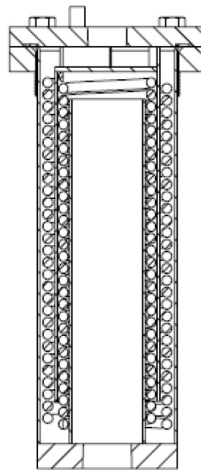
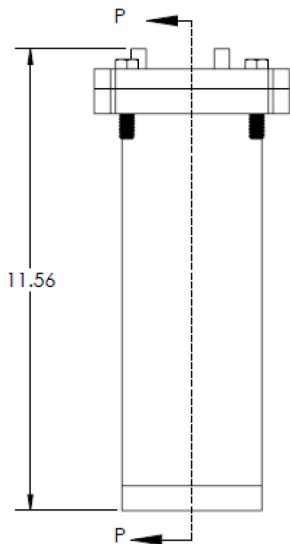
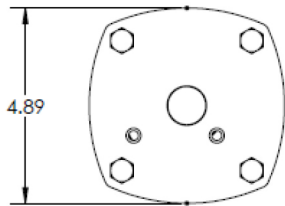

Missouri Filter & Process Equipment Co
MOFILCO-Quality, Value, Service
12025 Manchester Road, Suite 30G
St Louis MO 63131

314-821-4321 www.mofilco.com
mofilco@mofilco.com

Solutions
Incorporated

Solutions, Inc.
1174 E Bear Hollow Cir.
Draper, UT 84020

Phone: 801-576-8796
Fax: 801-568-2440
E-mail: info@samplepanels.com
Website: www.samplepanels.com